

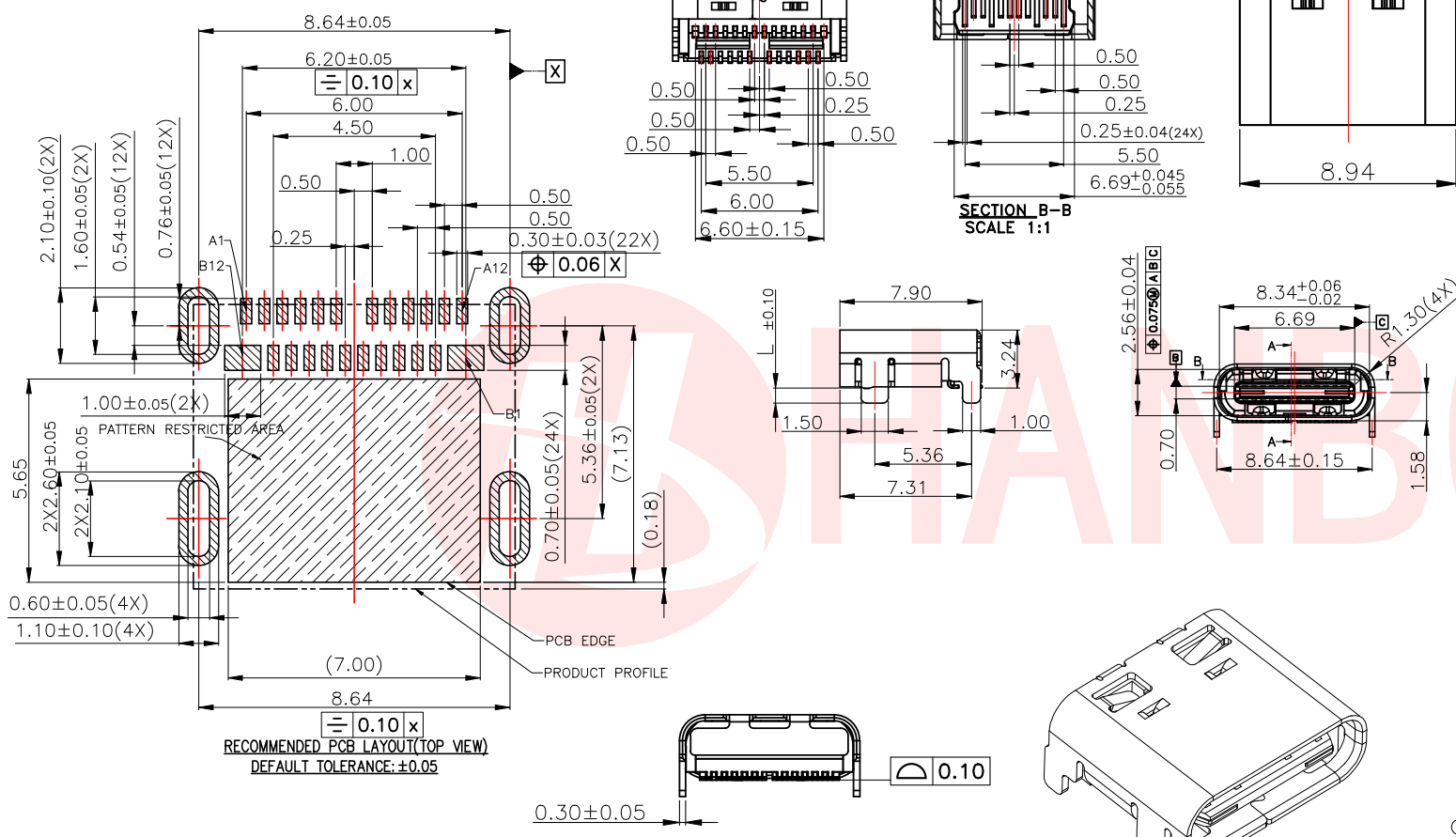

REV.	ECN NO OR DESCRIPTION	REVISED	DATE



- NOTE:
- MATERIAL SPECIFICATION:
    - HOUSING: LCP UL94 V-0 BLACK.
    - CONTACTS: C7025-TM02/C18400-R540 T=0.15mm
    - EMI SPRING: SUS304-1/2H T=0.10mm
    - FRONT SHELL: SUS304-1/2H T=0.3mm
    - MIDDLE BLADE: SUS301-H T=0.15
  - PLATING SPECIFICATION:
    - CONTACTS:
      - Ni 30μ MIN. UNDER PLATED OVER ALL.
      - 30μ Au PLATED ON THE FUNCTIONAL AREA OF CONTACT.
      - Au GOLD FLASH PLATED ON SOLDER AREA.
    - EMI SPRING: CLEANING ONLY
    - FRONT SHELL:
      - Ni 50μ MIN. UNDER PLATED OVER ALL.
      - 50μ Au G/F Min PLATED ON SOLDER AREA.
    - MIDDLE BLADE:
      - Ni 50μ MIN. UNDER PLATED OVER ALL.
      - 50μ Au G/F Min PLATED ON SOLDER AREA.
  - MECHANICAL PERFORMANCE:
    - INSERTION FORCE: 5~20N
    - REMOVAL FORCE: 8~20N FROM 1 TO 1000 CYCLES  
6~20N FROM 1001 TO 10000 CYCLES
    - DURABILITY: 10000 CYCLES.
  - ELECTRICAL PERFORMANCE:
    - CURRENT RATING: 5.0A FOR VBUS PINS (Pin A4,A9,B4,B9)  
1.25A FOR GND PINS (PIN A1,A12,B1,B2)  
0.25A FOR OTHER PINS (PIN A1,A12,B1,B2)
    - LLCR:
      - VBUS & GND PINS AND OTHER PINS: 40mA/PIN MAX.
      - SHIELD: 50mA/MAX.
      - LLCR MAX. CHANGE OF ALL PINS: 10mA
    - INSULATION RESISTANCE: 100MΩ MIN.
    - DIELECTRIC WITHSTAND VOLTAGE, AC 100V FOR 1 MINUTE.
  - ENVIRONMENTAL PERFORMANCE:
    - OPERATING TEMPERATURE: -30°C~+85°C.
  - IR REFLOW:
    - THE PEAK TEMPERATURE ON THE BOARD SHALL BE MAINTAINED FOR 10 SECONDS AT 260°C.

PIN ASSIGNMENT											
A1	A2	A3	A4	A5	A6	A7	A8	A9	A10	A11	A12
GND	TX1+	TX1-	VBUS	CC1	D+	D-	SBU1	VBUS	RX2-	RX2+	GND
GND	RX1+	RX1-	VBUS	SBU2	D-	D+	CC2	VBUS	TX2-	TX2+	GND
B12	B11	B10	B9	B8	B7	B6	B5	B4	B3	B2	B1

UNLESS OTHERWISE SPECIFIED TOLERANCES

DECIMALS: X :±0.35 X.X :±0.25 X.XX :±0.15

ANGLES: X :±2° X.X :±1°

东莞市汉博电子科技有限公司  
DONGGUAN HANBO TECHNOLOGY CO., LTD

TITLE: C母座双排贴片 24PIN 四脚DIP L=7.9mm莫仕款

DWN xiong PART NO. MC-222D

CHKD lee SCALE:1:1 UNIT: mm

APVD wang SIZE: A4 SHEET:10F 1 REV: A4

CUSTOMER COPY



REV.	ECN NO OR DESCRIPTION	REVISED	DATE

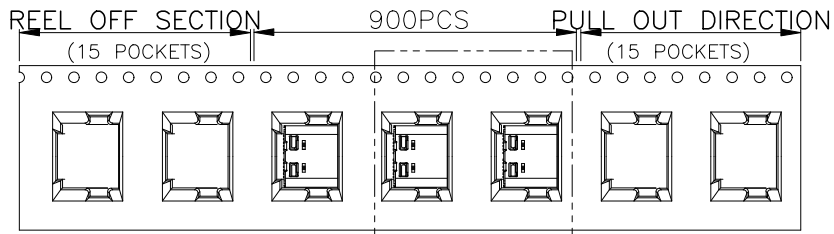

SEE DETAIL X

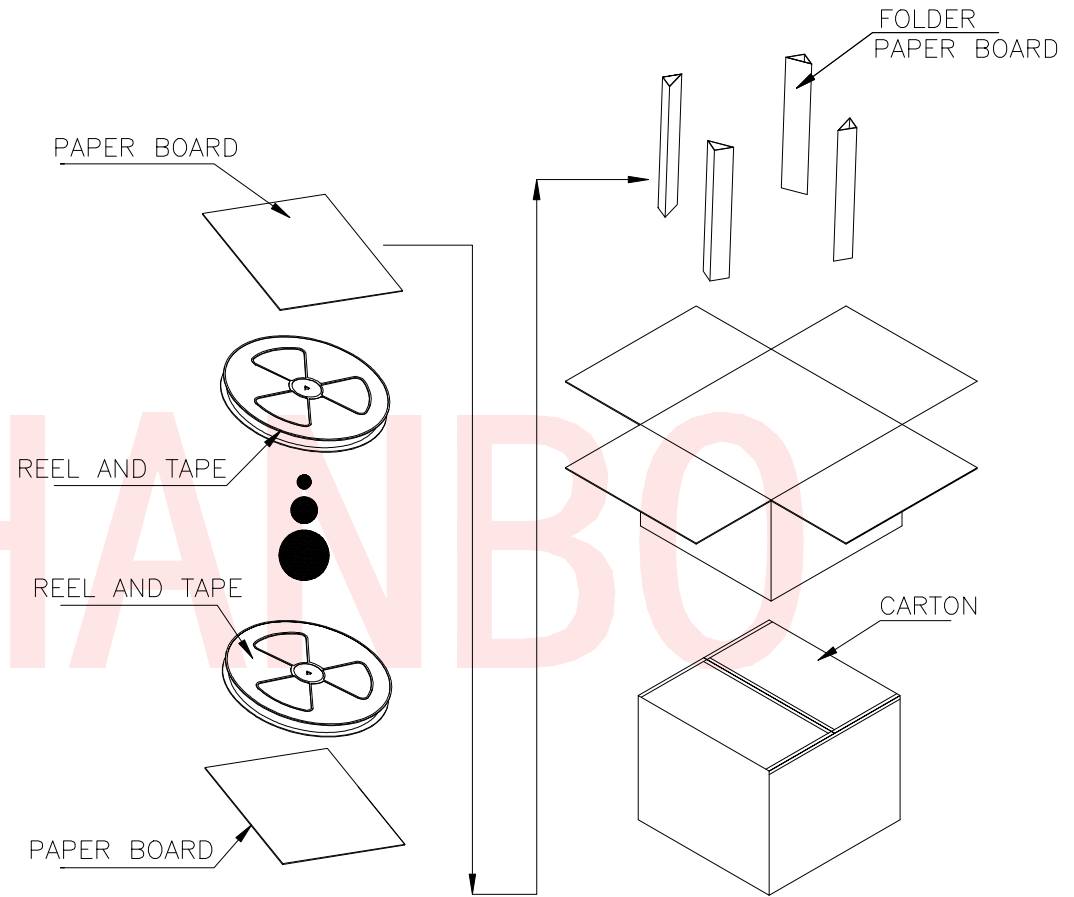
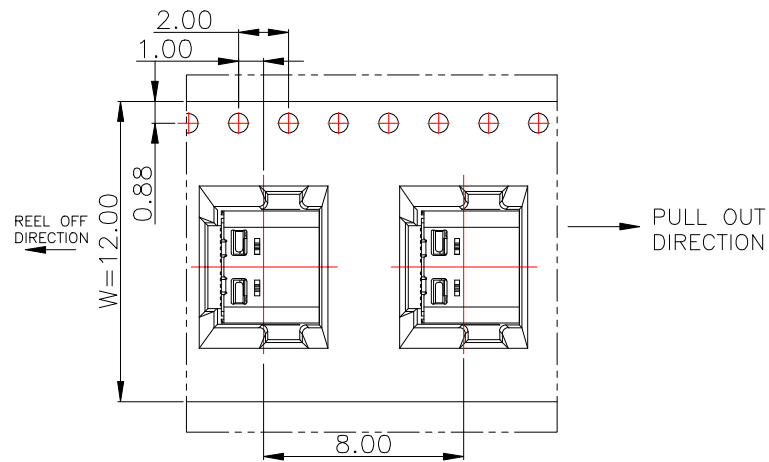
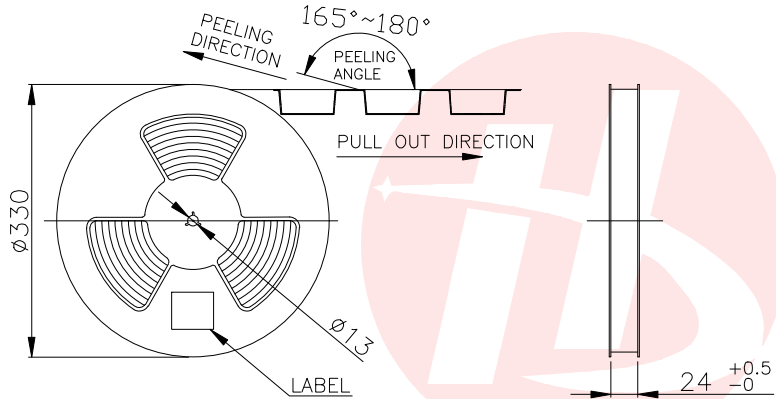

UNLESS OTHERWISE SPECIFIED TOLERANCES

DECIMALS:	ANGLES:
X : ±0.35	X : ±2°
X.X : ±0.25	X.X : ±1°
X.XX : ±0.15	



东莞市汉博电子科技有限公司  
 DONGGUAN HANBO TECHNOLOGY CO., LTD

TITLE	TYPE C 母座双排贴片 24PIN 四脚DIP L=7.9mm 莫仕款			
DWN	xiong	PART NO. MC-222D		
CHKD	lee	SCALE: 1:1	UNIT: mm	
APVD	wang	SIZE: A4	SHEET: 1 OF 1	REV: A4

CUSTOMER COPY